

Weld-On Lifting Hooks

Introducing two weld-on hooks from CM Industrial Products

Designed for welded attachment to front end loaders or other mobile lifting/excavation equipment. Other uses include lifting beams and spreader bars.

JD Weld-On Alloy Lifting Hook

- Designed so the latch will never carry load when used under normal conditions.
- Heavy duty forged latch interlocks with hook tip.
- Large weld pad on forged alloy steel hook.
- Trace code forged into each hook.
- Detailed welding instructions included with each hook.
- Available working load limit from one to ten tons.
- Hook design allows easy sling hook up.
- Thumb tab on latch for convenient sling removal.
- Sling eye can be attached to hook by "slip and pull" method.
- Each hook forged with load marks to assist user in locating correct load zone.

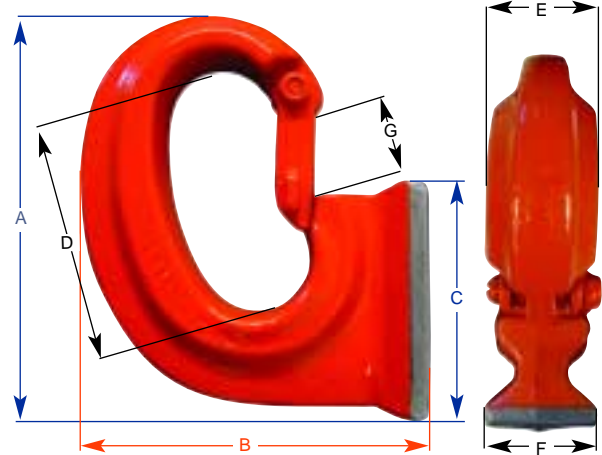

| Product Code | Dimensions (inches) | | | | | | | Working Load Limit (Tons) | Working Load Limit (Lbs.) | Approx. Wt. Ea. (Lbs.) |
|--------------|---------------------|-------|-------|-------|-------|-------|-------|---------------------------|---------------------------|------------------------|
| | A | B | C | D | E | F | G | | | |
| M4301 | 4.750 | 4.134 | 2.781 | 2.930 | 1.000 | 1.250 | 0.840 | 1 | 2,205 | 2.2 |
| M4303 | 5.984 | 4.719 | 3.743 | 3.340 | 1.250 | 1.297 | 0.980 | 3 | 6,615 | 4.6 |
| M4305 | 8.228 | 6.509 | 5.120 | 4.861 | 1.156 | 1.719 | 1.788 | 5 | 11,025 | 7.5 |
| M4310 | 11.306 | 8.457 | 6.937 | 7.050 | 1.781 | 2.469 | 1.980 | 10 | 22,050 | 22.5 |

Design factor 5:1.

Yale Import Weld-On Lifting Hook

- Heavy duty forged latch interlocks with hook tip.
- Large weld pad on forged steel hook.
- Each hook has full traceability.
- Detailed welding instructions included with each hook.
- Available working load limit from one to eight tons.
- Thumb tab on latch for convenient sling removal.
- Manufactured in China by a division of Columbus McKinnon Corporation.

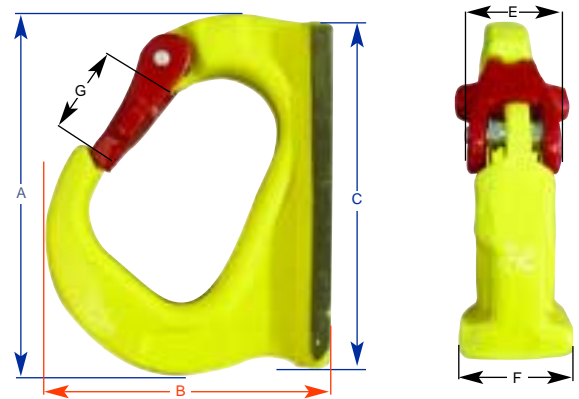

| Product Code | Dimensions (inches) | | | | | | Working Load Limit (Tons) | Working Load Limit (Lbs.) | Approx. Wt. Ea. (Lbs.) |
|--------------|---------------------|-------|-------|-------|-------|-------|---------------------------|---------------------------|------------------------|
| | A | B | C | E | F | G | | | |
| 48211 | 3.859 | 2.992 | 3.543 | 0.669 | 0.984 | 0.945 | 1 | 2,205 | 0.9 |
| 48212 | 5.406 | 4.134 | 5.118 | 0.945 | 1.378 | 1.142 | 3 | 6,615 | 2.9 |
| 48213 | 6.750 | 5.197 | 6.299 | 1.181 | 1.772 | 1.457 | 5 | 11,025 | 5.3 |
| 48214 | 7.641 | 5.433 | 6.693 | 1.575 | 1.969 | 1.850 | 8 | 17,640 | 8.5 |

Design factor 4:1



AMHERST, NEW YORK 14228-1197
 TEL: 800/888-0985 • 716/689-5400
 FAX: 716/689-5644

www.cmindustrial.com

WARNING Do not use for lifting people or loads over people. To avoid injury:

- Welding to be done only by qualified welder.
- Follow welding instructions included with each hook.
- If instructions are missing, contact Columbus McKinnon, 800-888-0985.